

# *Inter-American Oil Works, LTD.*

---

P.O. Box 69170  
2416 N F.M. 1936  
ODESSA, TEXAS 79769-0170  
OILWORKSINC@OILWORKSINC.COM

Telephone 432-381-5265  
800-531-3273  
Fax 432-381-7526  
WWW.OILWORKSINC.COM

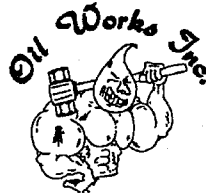

## **OWI 1200 EXPLORER WIRELINE UNIT**

### **OPERATING INSTRUCTIONS**

WIRELINE UNIT MUST BE RIGIDLY ATTACHED  
TO FLOOR SURFACE PRIOR TO ANY WIRELINE OPERATION

#### **ELECTRICAL**

Connect electric motor in accordance with instructions on the data plate attached to wireline unit frame. Refer to wiring schematic inside starter box cover. The electric motor must rotate in the direction indicated by arrow on hydraulic pump.

#### **WARNING**

A licensed electrician should be used to properly connect the explosion proof components.

#### **LIGHT WEIGHT TOOL BRAKING**

1. Do Not Run electric motor.
2. Disengage shifting clutch.
3. Let tool freefall by controlling speed with hand brake application.
4. Read depth on meter counter.

## **DYNAMIC BRAKING**

1. Do Not Run electric motor.
2. Engage clutch by shifting clutch lever to the "IN" position. Check for dog engagement through the window in clutch and motor guard. It may be necessary to rotate spool slightly in either direction to align dogs with hydraulic motor.
3. Let tool freefall, using hydraulic governor for braking.
  - a. Turn handle clockwise for more braking pressure.
  - b. Turn handle counterclockwise for less braking pressure.
  - c. System pressure gauge should indicate zero system pressure.
4. Read depth on meter counter.
5. For hand cranking or other purposes, move clutch lever to the "OUT" position.

## **RETRIEVING WIRE**

1. Be certain clutch is engaged.
2. Open hydraulic governor valve approximately three turns counterclockwise.
3. Engage hand brake.
4. Start electric motor.
5. Disengage hand brake.
6. Turn hydraulic governor clockwise slowly until spool begins to turn.
7. Power and speed are controlled by closing and opening hydraulic governor.
8. System pressure gauge will indicate system pressure in PSI.
9. Relief valve should be set just slightly over the load that will be handled to insure against the possibility of hanging up in the well when retrieving line and tools.
10. To set relief valve, loosen jam nut and turn knurled knob clockwise for more pressure and counterclockwise for less pressure. Retighten jam nut.
11. For emergency shut down, push stop button on starter box and engage hand brake.

### **CAUTION**

Do not attempt to engage or disengage clutch with hydraulic motor or spool rotating.

## **MAINTENANCE**

### **LUBRICATION**

The wireline unit has five grease zerk fittings as follows:

1. Two spool shaft pillow block bearings (Item No. 5 on Explorer Assembly Drawing).
2. Brake shaft support (Item No. 4) and brake shaft and ratchet support (Item No. 14 on Explorer Brake Assembly Drawing).
3. Yoke assembly (Item No. 5 on Shifting Yoke Assembly Drawing).

The pillow block bearings need very little lubrication, because they are sealed bearings and should not be filled to the point of rupturing the seals. One shot of good quality grease from a hand grease gun every month should be sufficient.

The brake shaft supports should be lubricated as needed. Once every three months is usually sufficient for normal operating conditions.

The yoke assembly will require the removal of the clutch and motor guard (Item No. 8 on Explorer Assembly Drawing). The yoke should be lubricated as needed, usually every month. When the clutch and motor guard is removed, apply a small amount of grease to the spool shaft spline while sliding dog clutch back and forth.

### **HYDRAULIC OIL**

Check frequently the oil level in the tank when the oil is cold and fill tank to about 1/4" above the bottom of filler screen. Use a good quality, non-foaming, anti-wear hydraulic oil. When adding hydraulic oil, be certain the oil is clean and does not contain any solid particles.

Use a premium quality hydraulic oil with a minimum 100 S.U.S. and maximum 500 S.U.S. operating viscosity.

### **HYDRAULIC OIL FILTER**

The hydraulic oil filter has a cooler coded indicator gauge. The unit must operate in the GREEN area. Should the unit operate in the RED area, this is an indication that the filter element needs to be replaced. Under normal operating conditions, the filter should operate in the GREEN for approximately 300 hours.

EXPLORER MODEL  
1200 WIRE LINE  
MACHINE

EXPLORE MODEL 1200 WIRELINE UNIT			12000
ITEM NO.	QTY.	DESCRIPTION	PART NO.
1	1	RETRIEVER FRAME	12001
2	1	HYDRAULIC TANK ASSEMBLY	12002
3	1	SPOOL	12003
4	1	SPOOL SHAFT	12004
5	2	PILLOW BLOCK BEARING	12005
6	1	SPOOL GUARD	12006
7	1	CLUTCH AND MOTOR GUARD	12007
8	1	HYDRAULIC MOTOR	16019
9	1	FOOT MOUNT	16020
10	1	KEYED DOG CLUTCH	12008
11	1	SPLINED DOG CLUTCH	12009
12	1	SHIFTING YOKE ASSEMBLY	12010
13	16	3/8-16 NC CAPSCREW X 1	12011
14	4	3/8-16 NC CAPSCREW X 1-3/4	12012
15	8	3/8-16 NC NUT	16010
16	12	1/2-13 NC CAPSCREW X 1-3/4	12013
17	12	1/2-13 NC NUT	16046
18	1	BRAKE ASSEMBLY	12014
19	1	EXPLOSION PROOF COUPLING	12015
20	1	15 HP ELECTRIC MOTOR	16057
21	1	STARTER BOX	16016
22	1	CAM FOLLOWER	12017
23	1	HYDRAULIC PUMP W/ FOOT MOUNT	16054
24	1	CHAIN COUPLING HALF, Chain	16056
25	1	CHAIN COUPLING HALF, Chain	16021
26	1	ROLLER CHAIN	12018
27	1	INLINE FILTER	16116
28	1	SYSTEM PRESSURE GAUGE	12019
29	1	RIGHT SIDE EXPANDED METAL COVER	12020
30	1	FRONT EXPANDED METAL COVER	12021
31	1	VALVE PANEL EXPANDED METAL COVER	12022
32	1	LEFT SIDE EXPANDED METAL COVER	12023
33	14	SELF TAPPING SHEET METAL SCREW	16081
34	1	VAVLE, HYDRAULIC GOVERNOR	16067
35	1	VALVE, RELIEF	16064
36	1	VAVLE, CHECK	16060
37	2	37 DEGREE JIC SWIVEL	12024
38	1	1" LOW PRESSURE HOSE X 38	12025
39	1	3/4" HIGH PRESSURE HOSE X 60	12026
40	1	3/4" HIGH PRESSURE HOSE X 21	12027
41	1	3/4" LOW PRESSURE HOSE X 26	12028
42	1	3/4" LOW PRESSURE HOSE X 22	12029

43	1	3/4" LOW PRESSURE HOSE X 36	12030
44	1	3/4" HIGH PRESSURE HOSE X 20	12031
45	1	3/4" NPT TEE W/MOUNTING BRACKET	12032
46	1	3/4" NPT STREET ELBOW	12033
47	3	3/4" NPT CLOSE NIPPLE	12034
48	1	TUBING ADAPTER	12035
49	1	45 DEGREE TUBING ADAPTER	12036
50	54	1/4-20 NC CAPSCREW X 1/2	12037
51	1	POST, RACK ARM	16049
52	1	90 DEGREE TUBING ADAPTER	12038

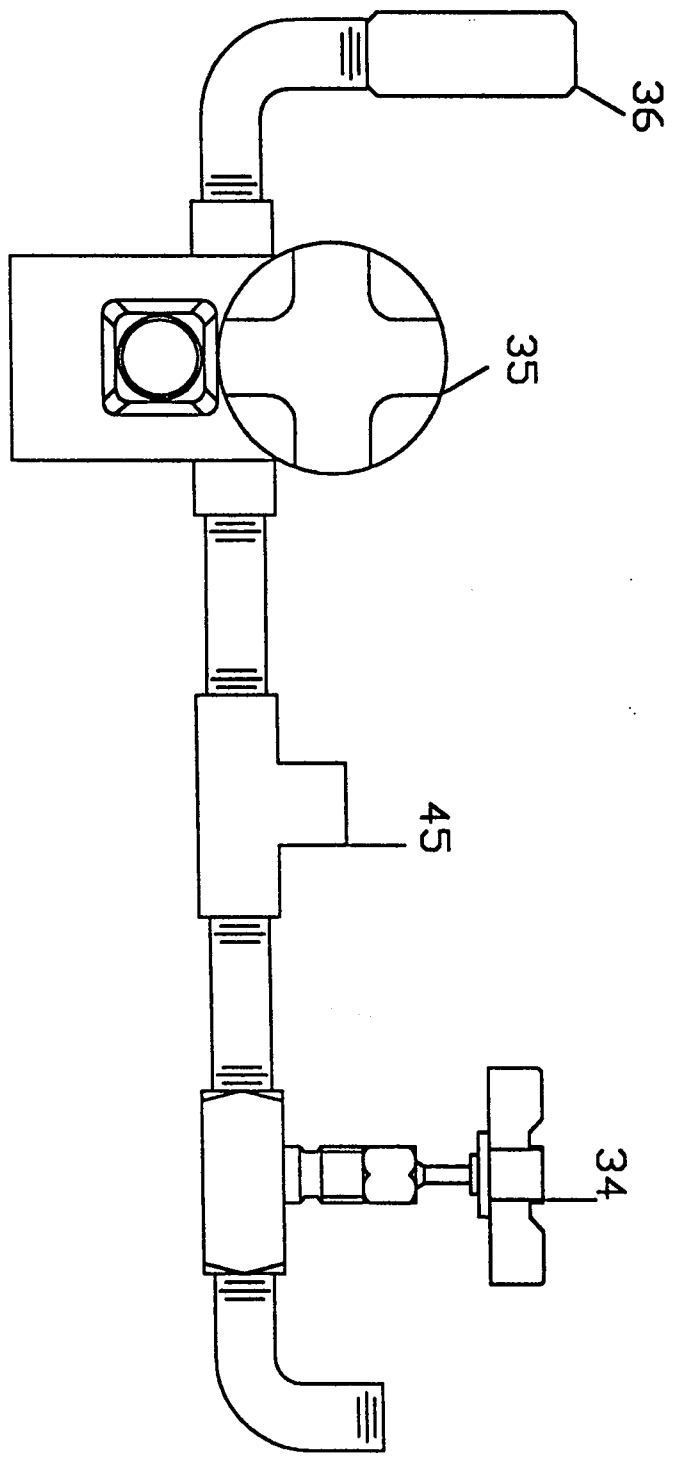

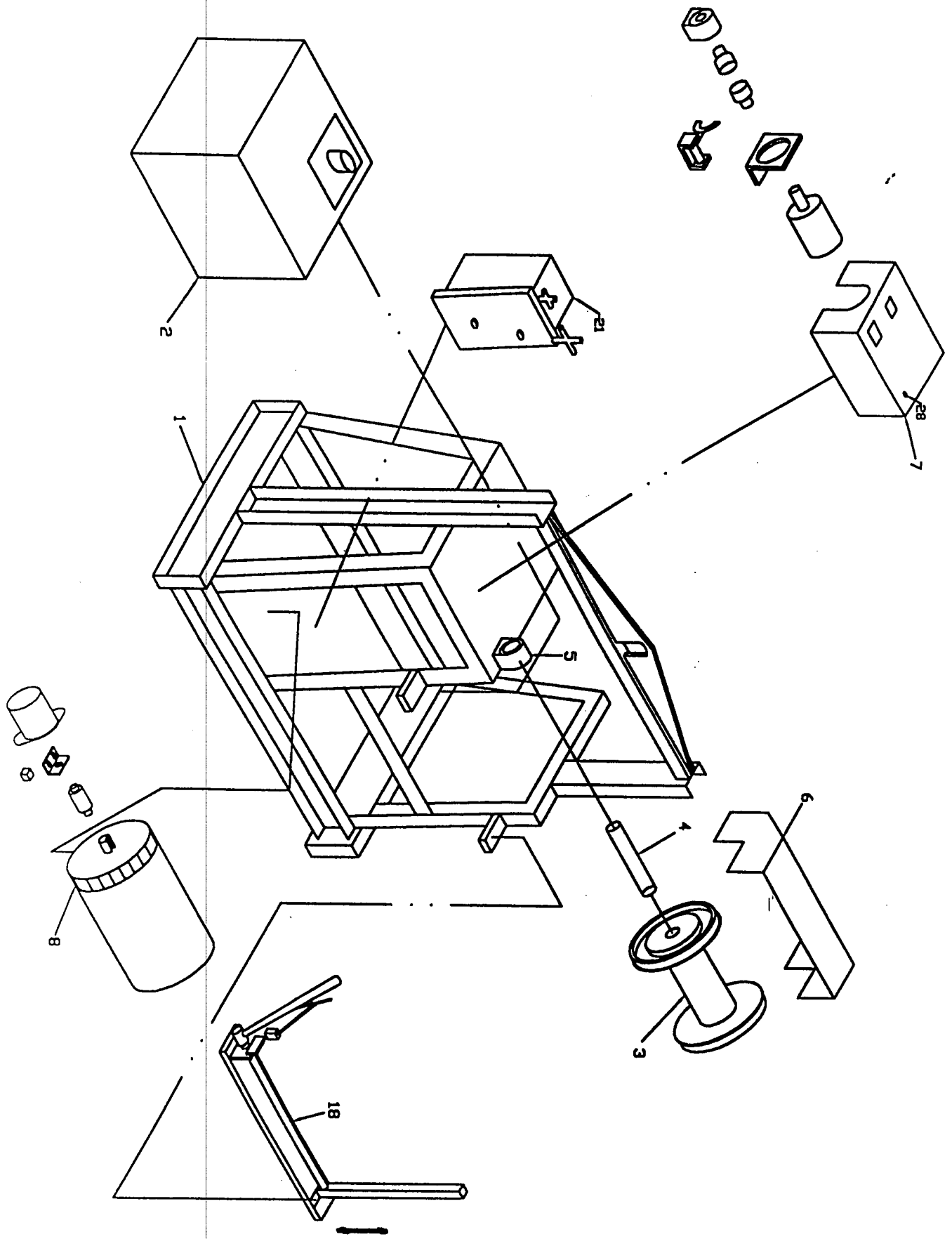



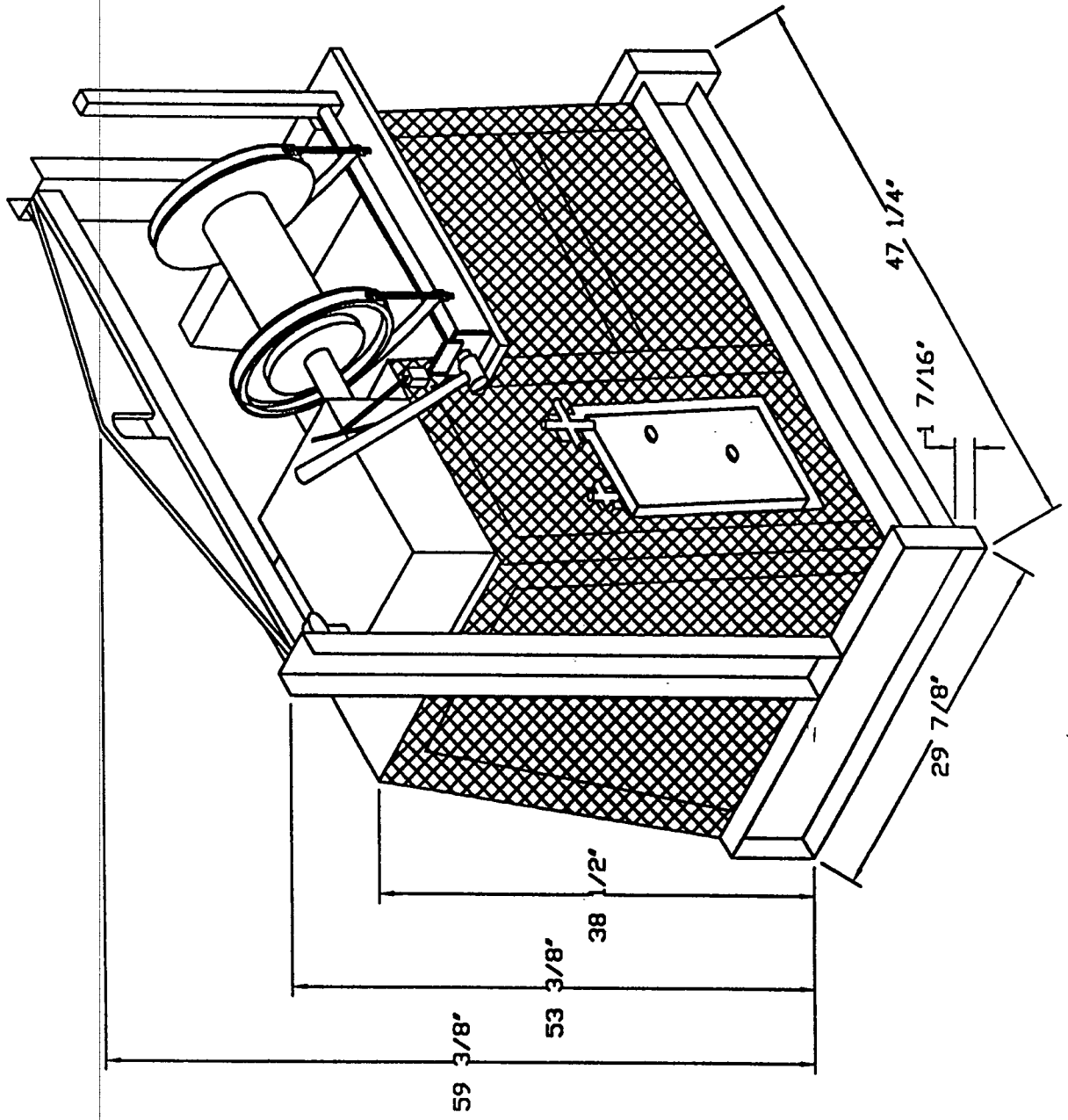

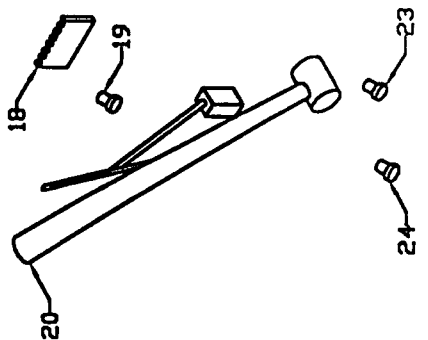
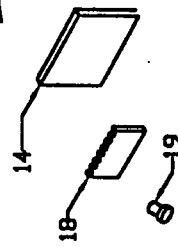
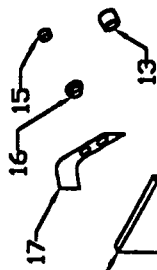
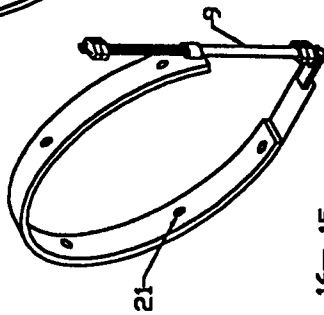
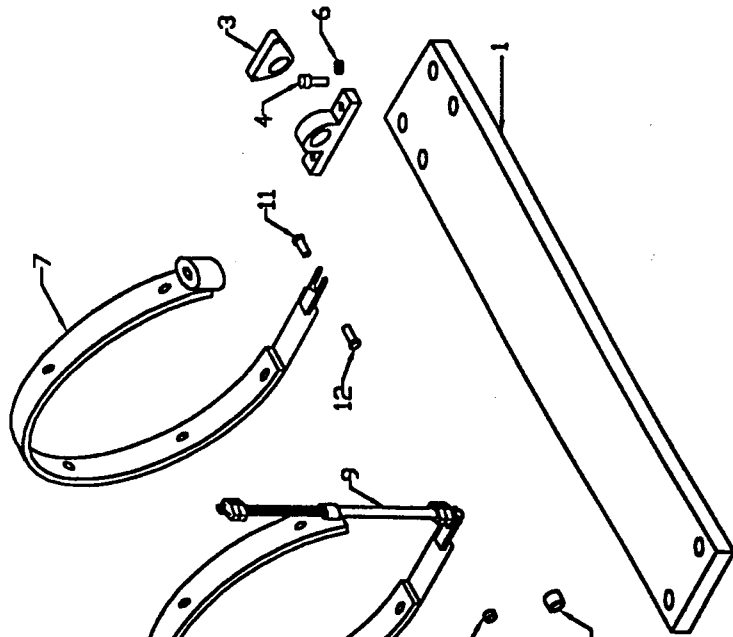
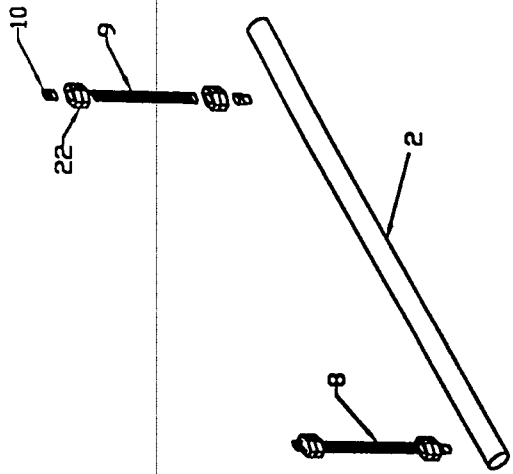

EXPLORER MODEL 1200 WIRELINE UNIT  
BRAKE ASSEMBLY  
PART NO. 12014

ITEM #	QTY.	DESCRIPTION	PART NO.
1	1	BASE PLATE	16091
2	1	BRAKE SHAFT INCLUDING KEYS	16092
3	2	BELL CRANK	16093
4	1	BRAKE SHAFT SUPPORT BRACKET	16094
5	4	3/8"-16 NC HEX HEAD BOLTS X 1-1/2"	16095
6	4	3/8" LOCK WASHER	16096
7	2	BRAKE BAND W/ LINING (INCLUDES ITEMS 11, 12, & 21)	12040
8	2	BRAKE ADJUSTMENT ROD (INCLUDES ITEMS 11& 12)	16098
9	2	BAND ADJUSTMENT SPRINGS	16099
10	6	1/2"-13 NC HEX NUT	16100
11	4	CLEVIS PIN 1/2" X 1-5/8"	
12	4	COTTER PIN	
13	1	SHAFT COLLAR	16101
14	1	BRAKE SHAFT & RATCHET SUPPORT	16102
15	2	5/16"-18 NC HEX NUT	16103
16	2	5/16" LOCK WASHER	16104
17	1	STOP FOR BRAKE LEVER	16105
18	1	RATCHET	16106
19	2	5/16-18 NC FLAT HEAD MACH. SCREW X 1-1/4"	16107
20	1	BRAKE LEVER ASSEMBLY	16108
21	2	BRAKE LINING W/ RIVETS	
22	2	SPRING GUIDE NUT (1/2-13NC)	16109
23	1	3/8-16 NC HEX HEAD BOLT X 1-3/4"	16110
24	1	3/8-16 NC NUT	16111

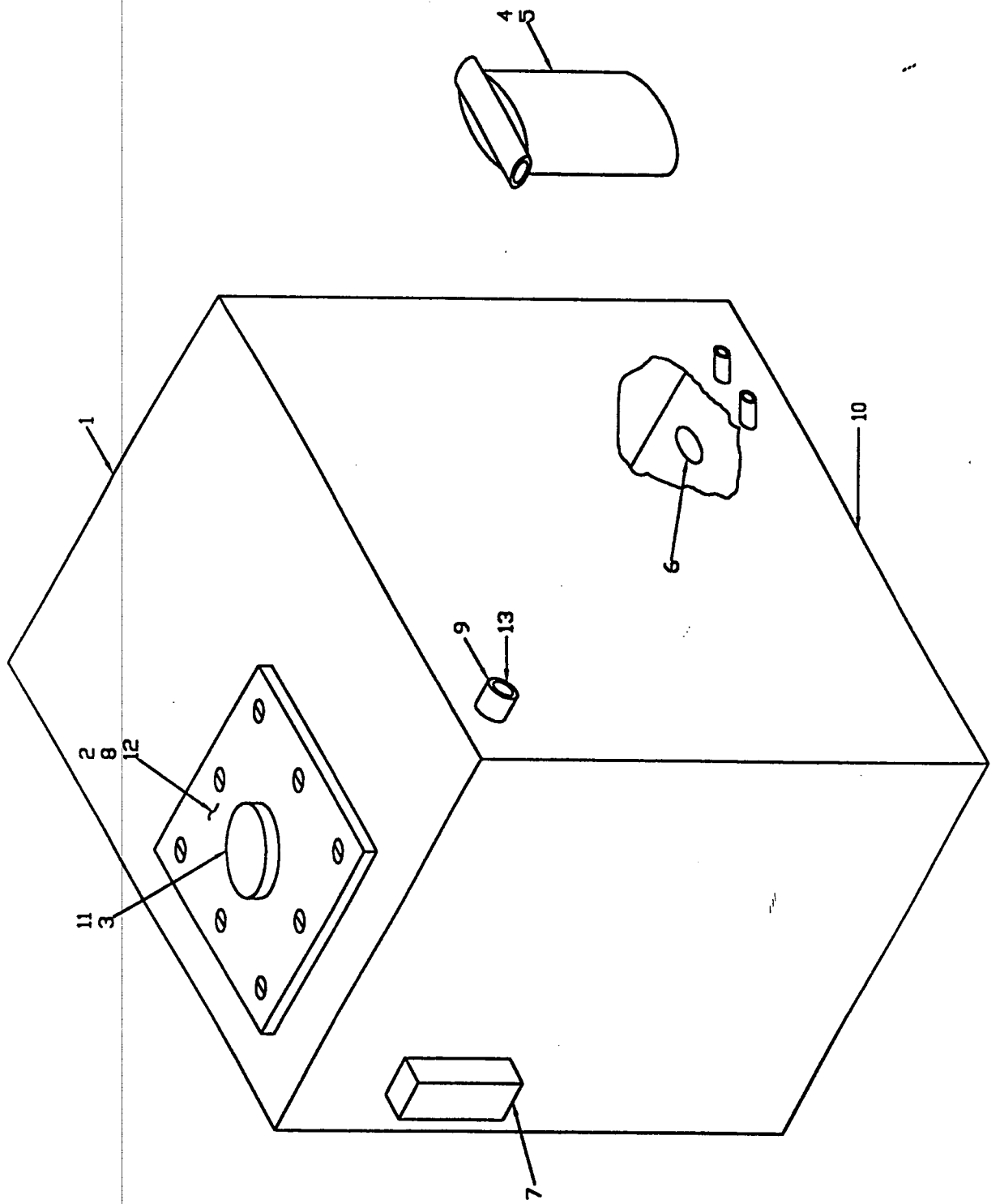

EXPLORER MODEL 1200 WIRELINE UNIT HYDRAULIC OIL TANK ASSEMBLY			12002
ITEM NO.	QTY.	DESCRIPTION	PART NO.
1	1	TANK SHELL	12039
2	1	PLATE, FILLER CAP	16113
3	1	CAP, FILLER	16114
4	1	GAUGE, FILLER BYPASS	16115
5	1	FILTER, INLINE (INCLUDES ITEM 9)	16116
6	1	STRAINER	16117
7	1	GAUGE, SIGHT (3" UC-3101)	16118
8	1	GASKET	16119
9	1	NIPPLE, PIPE (3/4 NPT X 1-1/2 lg.)	16120
10	1	PLUG, Sq. Hd. (1/2 NPT)	16121
11	6	SCREW, Mach.- Rd. Hh. (#10-32 X 3/4 lg.)	16122
12	8	SCREW, Sheet Metal (#10 X 1/2 Type AB)	16123
SPO		ELEMENT, FILTER (Service Part for Item 5)	16124
13	1	Bushing, Hex 1-1/4 to 3/4 NPT	16125